

EXISTING FEATURES NOTES

GENERAL SITE PLAN INFORMATION

1. THIS SITE PLAN CONSISTS OF 4 DRAWINGS AND MUST BE READ COLLECTIVELY.
 2. ALL MEASUREMENTS SHOWN ON THIS SITE PLAN ARE IN METRES.

LICENCE INFORMATION

3. THIS SITE PLAN IS PREPARED FOR SUBMISSION TO THE MINISTRY OF NORTHERN DEVELOPMENT, MINES, NATURAL RESOURCES AND FORESTRY UNDER THE AGGREGATE RESOURCES ACT FOR A CLASS 'A' LICENCE, PIT BELOW THE WATER TABLE.
 4. APPLICANT: ST. MARYS CEMENT INC. (CANADA) 55 INDUSTRIAL STREET TORONTO, ONTARIO M4G 3W9

BASE INFORMATION

5. TOTAL AREA TO BE LICENCED: 35.2 ha
 TOTAL AREA TO BE EXTRACTED: 22.4 ha
 TOTAL AREA TO BE REHABILITATED: 22.4 ha

6. TOPOGRAPHIC INFORMATION FOR LOT 8 & 9, CONCESSION 2 WAS OBTAINED FROM FIRST BASE SOLUTIONS APRIL 25, 2019. ALL ELEVATIONS ARE GEODETIC AND ABOVE SEA LEVEL (ASL).
 THE SITE WAS FIELD CHECKED BY HARRINGTON MCANAVAN LTD. JUNE 3, 2019.

7. ZONING INFORMATION OBTAINED FROM SCHEDULE A, TOWNSHIP OF BROCK, ZONING BY-LAW NO. 278-75/PL, PLATE 'A', DATED MARCH 2019. MAJORITY OF PROPOSED LICENCE IS PRESENTLY ZONED RU (RURAL) AND EP (ENV. PROTECTION). A ZBA WILL BE APPLIED FOR TO CHANGE RU TO M4 (EXTRACTIVE INDUSTRIAL).

HYDROGEOLOGICAL INFORMATION

8. HYDROGEOLOGICAL INFORMATION INCLUDING GROUNDWATER ELEVATION WAS OBTAINED FROM REPORT BY GOLDER DATED JULY 2021.
 9. THE GROUNDWATER ELEVATION BODIES ACROSS THE SITE AND RANGES FROM 270-293m ABOVE SEA LEVEL (A.S.L.) BASED ON GOLDER REPORT.

10. THE SITE IS LOCATED WITHIN THE LAKE SIMCOE SOURCE PROTECTION REGION. SOURCE WATER PROTECTION POLICIES DO NOT APPLY TO THIS SITE. REFER TO HYDROGEOLOGICAL REPORT. NO MITIGATION IS REQUIRED.

TECHNICAL REPORTS

11. HYDROGEOLOGICAL INFORMATION WAS OBTAINED FROM REPORT BY GOLDER DATED JULY 2021 (REFER TO SHEET 2 FOR TECHNICAL RECOMMENDATIONS).
 12. NATURAL ENVIRONMENT INFORMATION WAS OBTAINED FROM REPORT BY GOLDER DATED JULY 2021 (REFER TO SHEET 2 FOR TECHNICAL RECOMMENDATIONS).
 13. ARCHAEOLOGICAL INFORMATION WAS OBTAINED FROM REPORT BY GOLDER DATED MARCH 31, 2020 (REFER TO SHEET 2 FOR TECHNICAL RECOMMENDATIONS).
 14. ACUSTICAL INFORMATION WAS OBTAINED FROM NOISE REPORT BY GOLDER DATED JULY 2021 (REFER TO SHEET 2 FOR TECHNICAL RECOMMENDATIONS).

KEY MAP

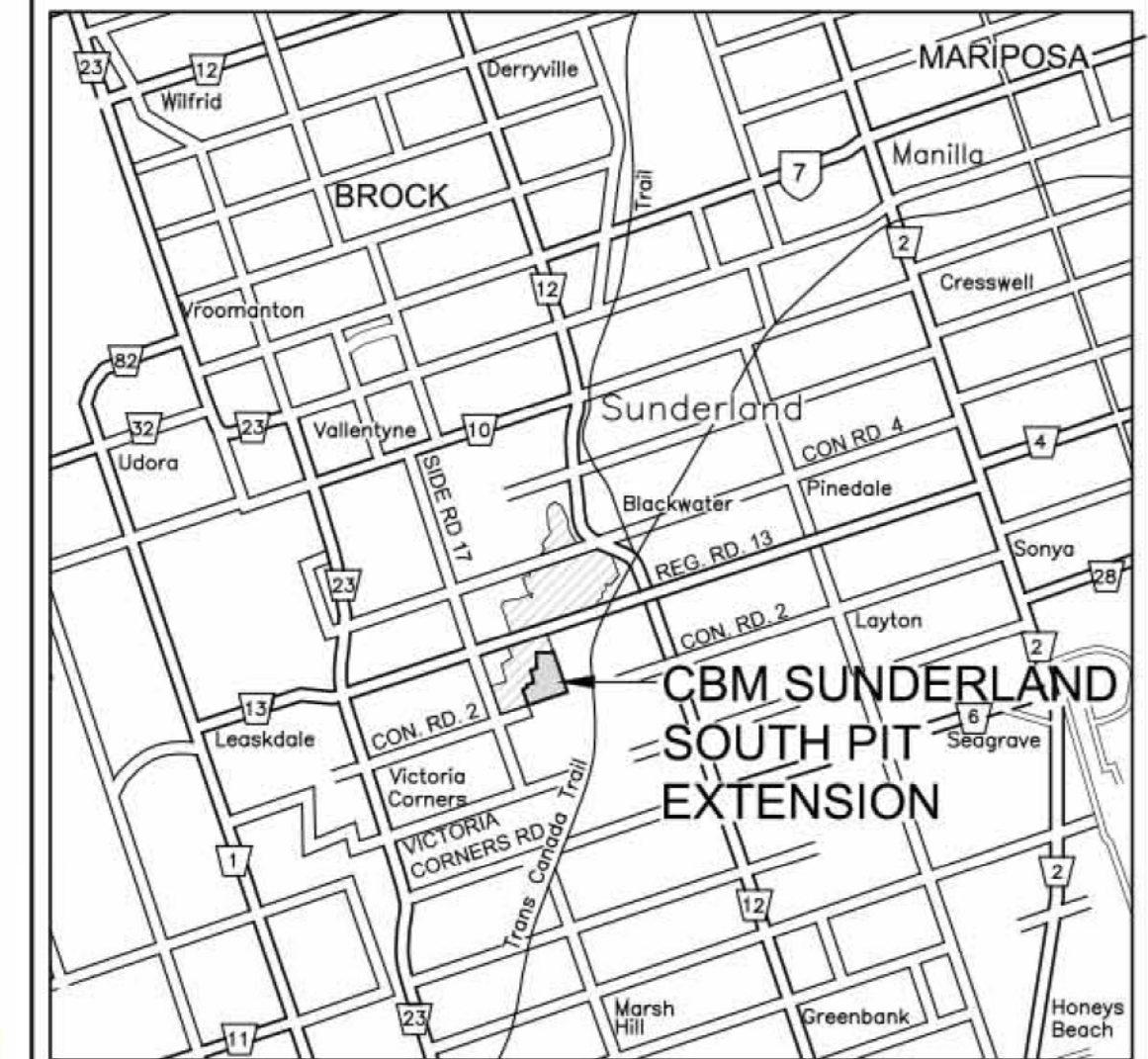

LEGEND

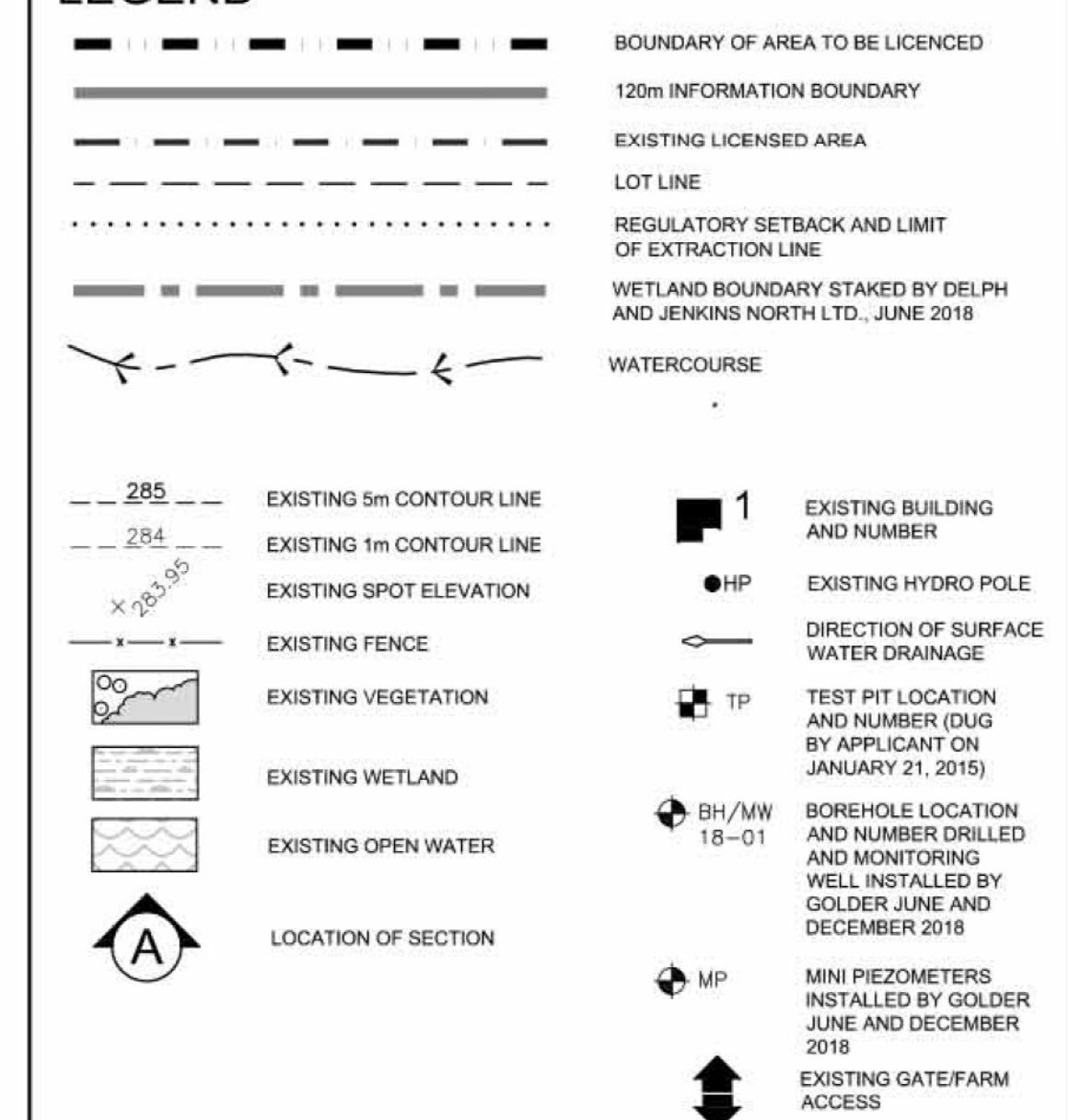

BUILDING LIST

No.	Description
1.	GARAGE
2.	HOUSE
3.	GARAGE
4.	HOUSE
5.	SHED

No.	Date	Revised	By	Checked	By
2	DEC	PER NDNRFP 2022			
1	JUNE	PER NDNRFP 2022			

Pre Licence Review | Site Plan Amendments

41 Main Street, Unit 102
 Unionville, Ontario L3R 2E5
 Tel: 905-204-6232 Fax: 905-204-7023
 www.harringtonmcanavan.com

Project Name

St. Marys Cement Inc. (Canada)
 55 Industrial Street
 Toronto, Ontario
 M4G 3W9
 (416) 423-1300

CBM Sunderland South Pit Expansion

APPLICANT SIGNATURE: _____
 LICENCE No. _____
 PART LOT 7 AND 8, CONCESSION 2
 TOWNSHIP OF BROCK, REGION OF DURHAM

Scale 1:2000

Stamp: REGISTRATION OF LANDS

Drawing Status: SUBMITTED FOR NDNRFP APPROVAL

Drawn SB	Checked RM	Issue Date DEC 2022
Drawing Title	Project Number	18-44
EXISTING FEATURES PLAN		Drawing Number
		1 OF 4

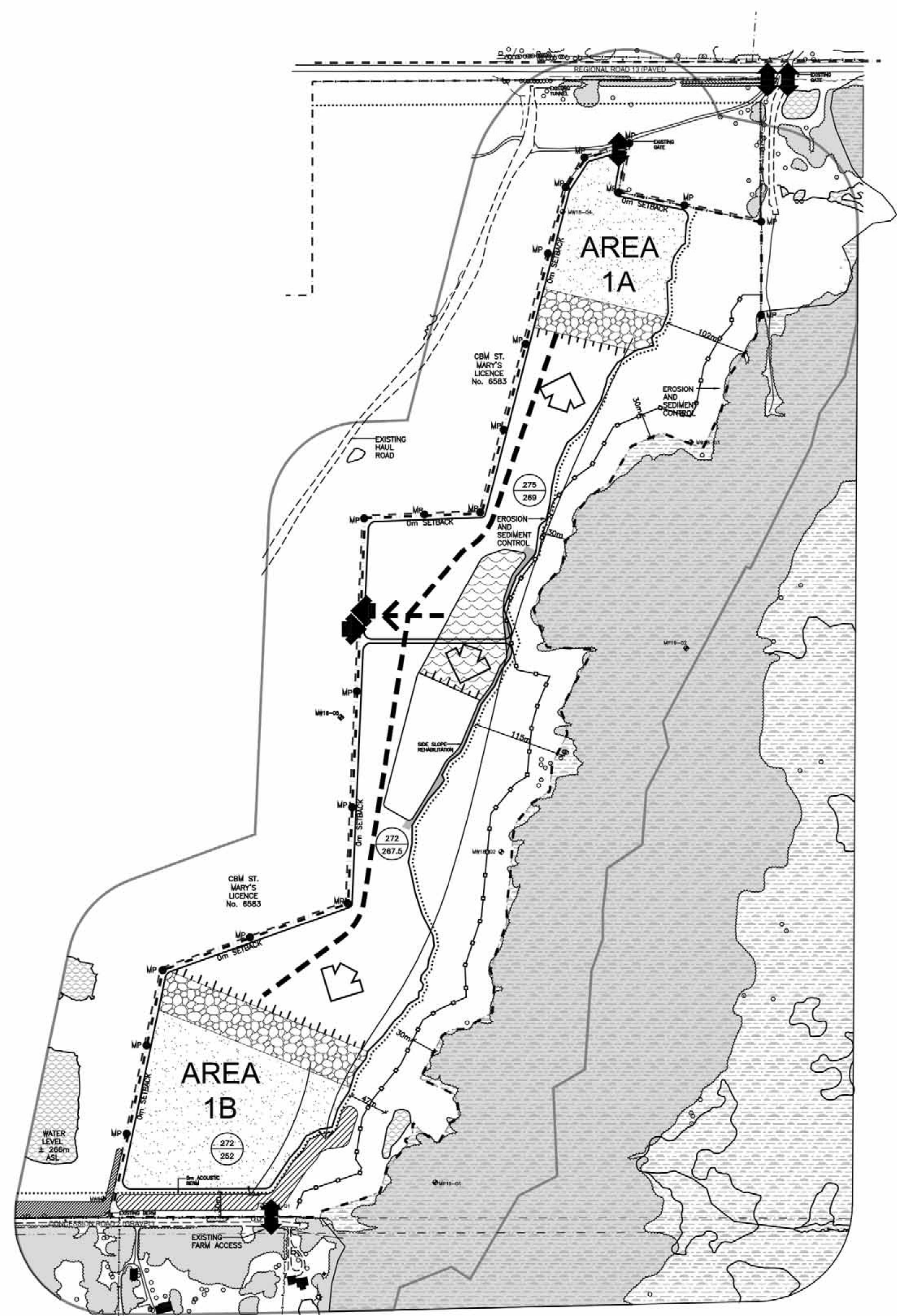

- ### PHASE B PHASE B NOTES
- CONTINUE PLANTING WHITE PINE TREE SCREEN IN EASTERN SETBACK AND CONTINUE ABOVE WATER EXTRACTION IN DIRECTIONS SHOWN.
 - PRIOR TO BELOW WATER EXTRACTION IN AREA 1A AND 1B, STAKE BELOW WATER LIMITS AND BEGIN PROGRESSIVE REHABILITATION OF EASTERN SLOPES OF CENTRAL POND AREA USING TOPSOIL STRIPPED FROM AREAS 1A AND 1B.
 - PRIOR TO BELOW WATER EXTRACTION IN AREA 1B, INCREASE HEIGHT OF ACOUSTIC BERM TO 5m USING TOPSOIL AND OVERBURDEN STRIPPED FROM AREAS 1A AND 1B.
 - PROGRESSIVE REHABILITATION OF EAST SLOPES IN AREA 1A AND 1B WILL BEGIN AND FOLLOW THE OPERATIONS IN THE DIRECTIONS SHOWN. COMMON BOUNDARY SIDE SLOPES SHALL BE REHABILITATED AS OPERATIONS ALONG THESE BOUNDARIES CEASE.
 - ABOVE AND BELOW WATER EXTRACTION MAY OCCUR SIMULTANEOUSLY ACCORDING TO MARKET DEMAND AND FOR BLENDING.
 - BEGIN BELOW WATER EXTRACTION IN DIRECTIONS SHOWN. MATERIAL EXTRACTED FROM BELOW WATER WILL BE PLACED IN WINDROWS ON THE PIT FLOOR TO DRAIN BEFORE BEING TRANSPORTED FOR PROCESSING.
 - UNDISTURBED PORTIONS OF AREAS 1A AND 1B REMAIN AGRICULTURAL USE.
 - MAINTAIN ALL VEGETATION IN A HEALTHY, VIGOROUS GROWING CONDITION.

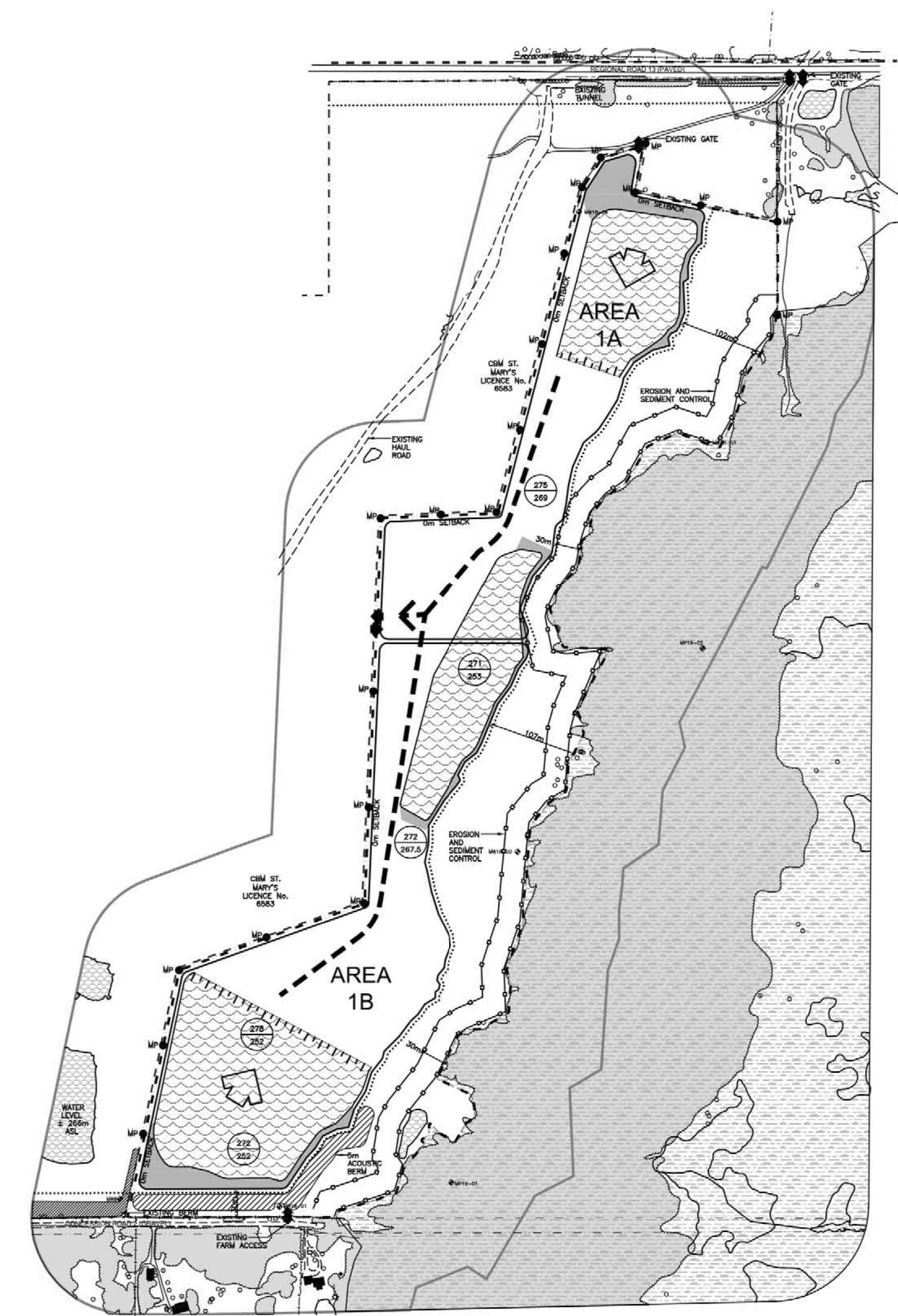

- ### PHASE C PHASE C NOTES
- COMPLETE PLANTING TREE SCREEN IN EASTERN SETBACK AND COMPLETE ABOVE WATER EXTRACTION IN AREAS 1A AND 1B.
 - ABOVE AND BELOW WATER EXTRACTION MAY OCCUR SIMULTANEOUSLY ACCORDING TO MARKET DEMAND AND FOR BLENDING.
 - CONTINUE BELOW WATER EXTRACTION IN AREAS 1A AND 1B. MATERIAL EXTRACTED FROM BELOW WATER WILL BE PLACED IN WINDROWS ON THE PIT FLOOR TO DRAIN BEFORE BEING TRANSPORTED FOR PROCESSING.
 - COMPLETE ALL EAST SLOPE REHABILITATION EXCEPT WHERE COMMON BOUNDARY OPERATIONS ARE STILL OCCURRING. BEGIN SHORELINE REHABILITATION OF EAST SLOPES OF NORTH POND AND EAST/SOUTH SHORELINE OF SOUTH POND USING TOPSOIL AND OVERBURDEN STOCKPILED ON THE PIT FLOOR.

- ### PHASE D (NOT SHOWN) PHASE D NOTES
- COMPLETE BELOW WATER EXTRACTION IN AREAS 1A AND 1B.
 - CONTINUE REHABILITATION OF ALL SHORELINES AND SIDE SLOPES USING MATERIAL FROM ACOUSTIC BERM.
 - REMOVE ALL SCRAP AND EQUIPMENT AND COMPLETE REHABILITATION OF AREA 1A AND 1B.
 - COMPLETE REHABILITATION OF ALL REMAINING AREAS INCLUDING ALL INTERNAL HALL ROADS USING STOCKPILED TOPSOIL AND OVERBURDEN AND MATERIAL FROM REMAINING BERM.
 - RETURN SITE TO NATURAL AREAS.

LEGEND

	BOUNDARY OF AREA TO BE LICENCED		120m INFORMATION BOUNDARY
	EXISTING LICENCED AREA		LOT LINE
	REGULATORY SETBACK AND LIMIT OF EXTRACTION LINE		WATERCOURSE
	EXISTING FENCE		EXISTING BUILDING
	EXISTING VEGETATION		EXISTING HYDRO HOLE
	EXISTING WETLAND		EXISTING GATEFARM ACCESS
	AREA STRIPPED OF TOPSOIL AND OVERBURDEN		BOREHOLE LOCATION AND NUMBER DRILLED AND MONITORING WELLS INSTALLED BY GOLDER
	BELOW WATER EXTRACTION		MINI PIEZOMETERS INSTALLED BY GOLDER
	PROGRESSIVE REHABILITATION		ENTRANCE EXIT
	EXTRACTION FACE		DIRECTION OF EXTRACTION
	BERM (MIN. HEIGHT AS SHOWN)		DIRECTION OF TOPSOIL AND OVERBURDEN MOVEMENT
	UNDISTURBED AREA		PRODUCT TRANSPORTATION VIA HAUL ROAD
	SILT EXCLUSION FENCE		LOCATION OF NOISE RECEPTOR
	PROPOSED MARKER POST		EXISTING ELEVATION
			PROPOSED ELEVATION

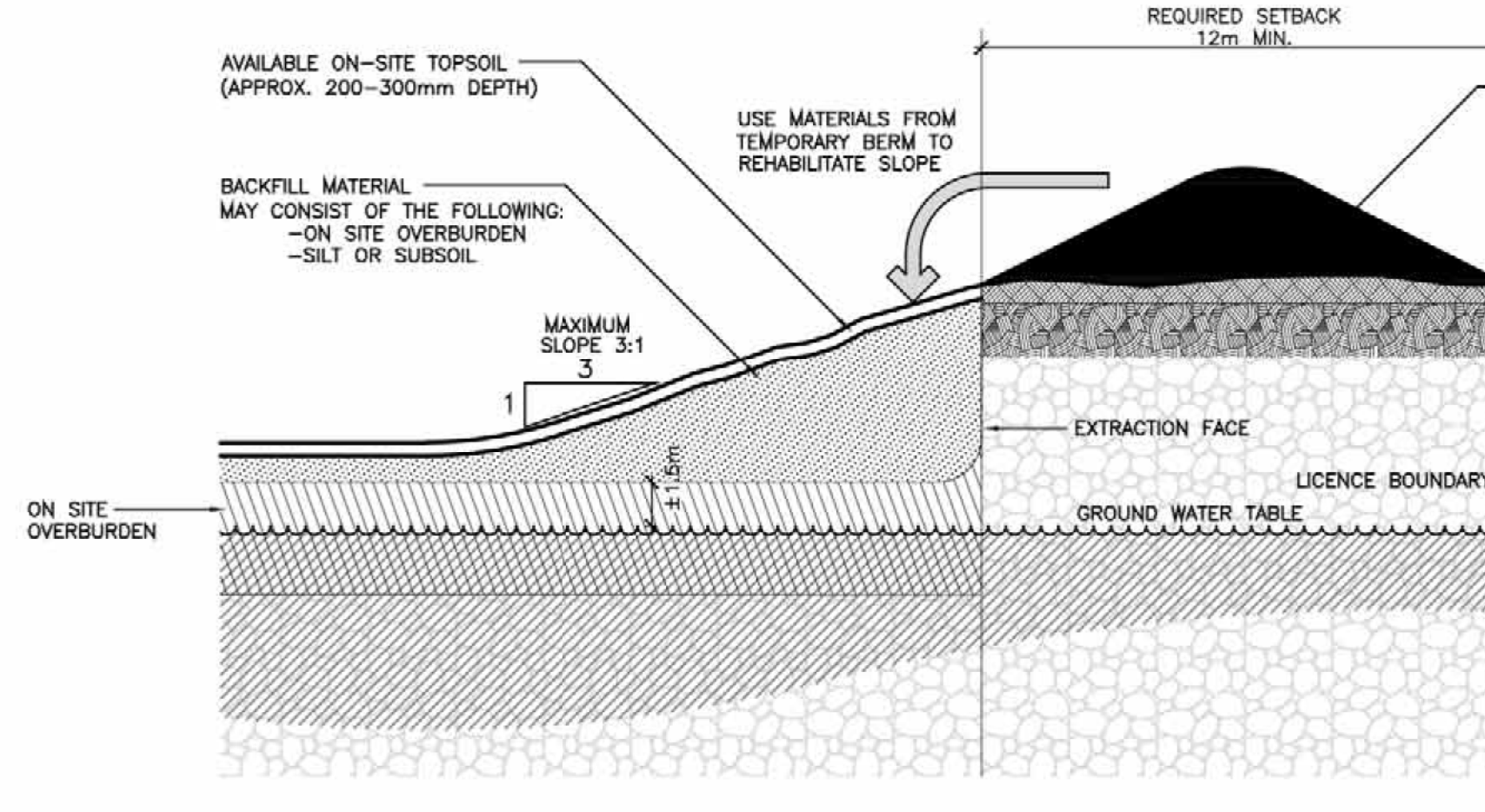
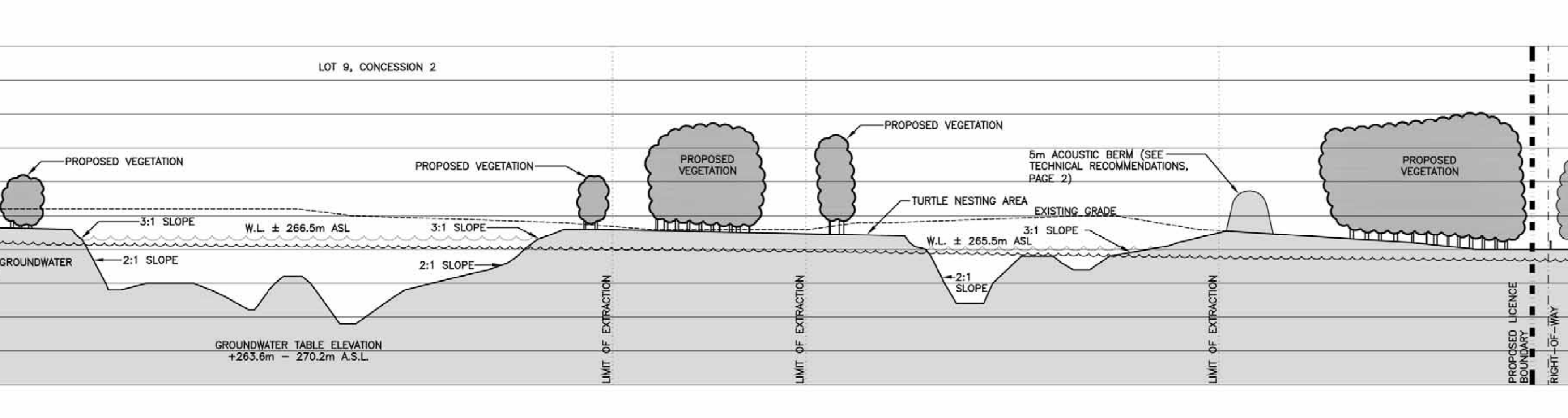
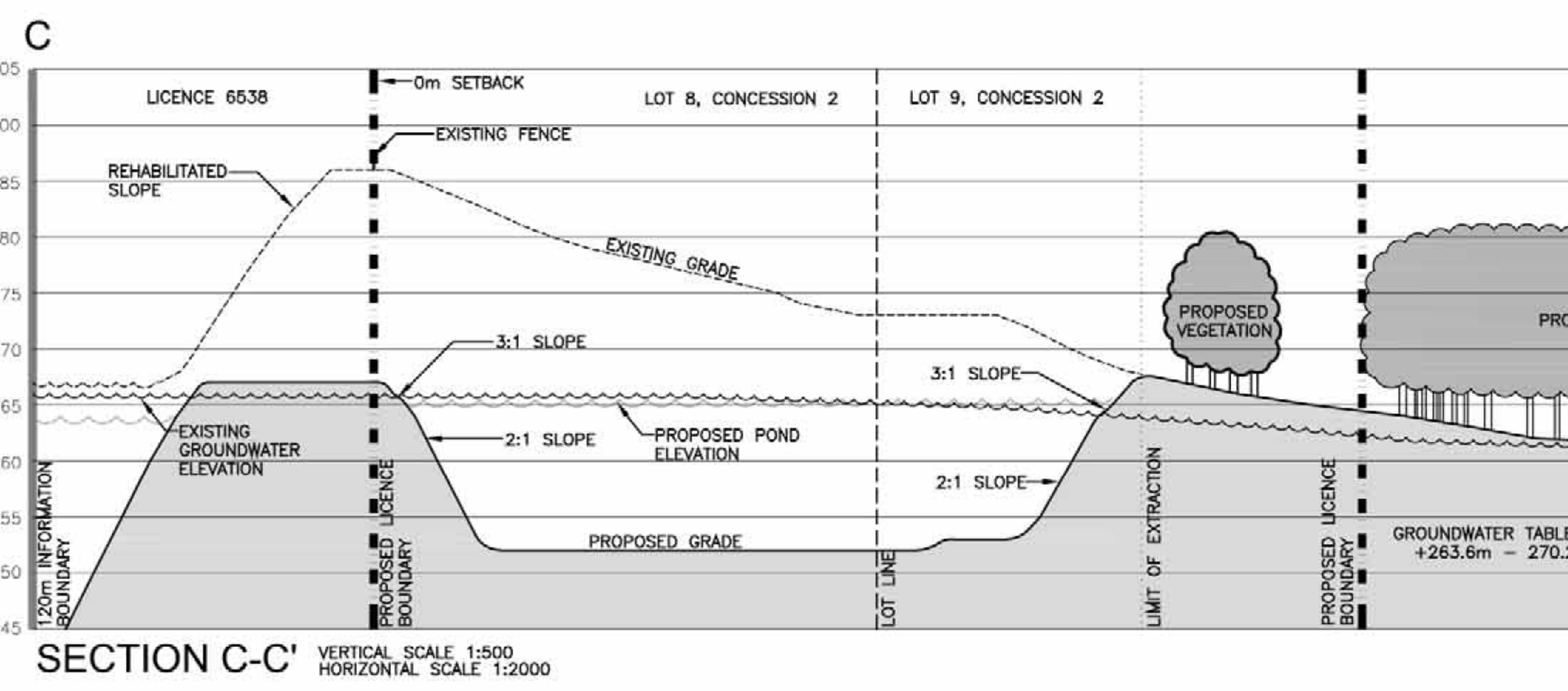
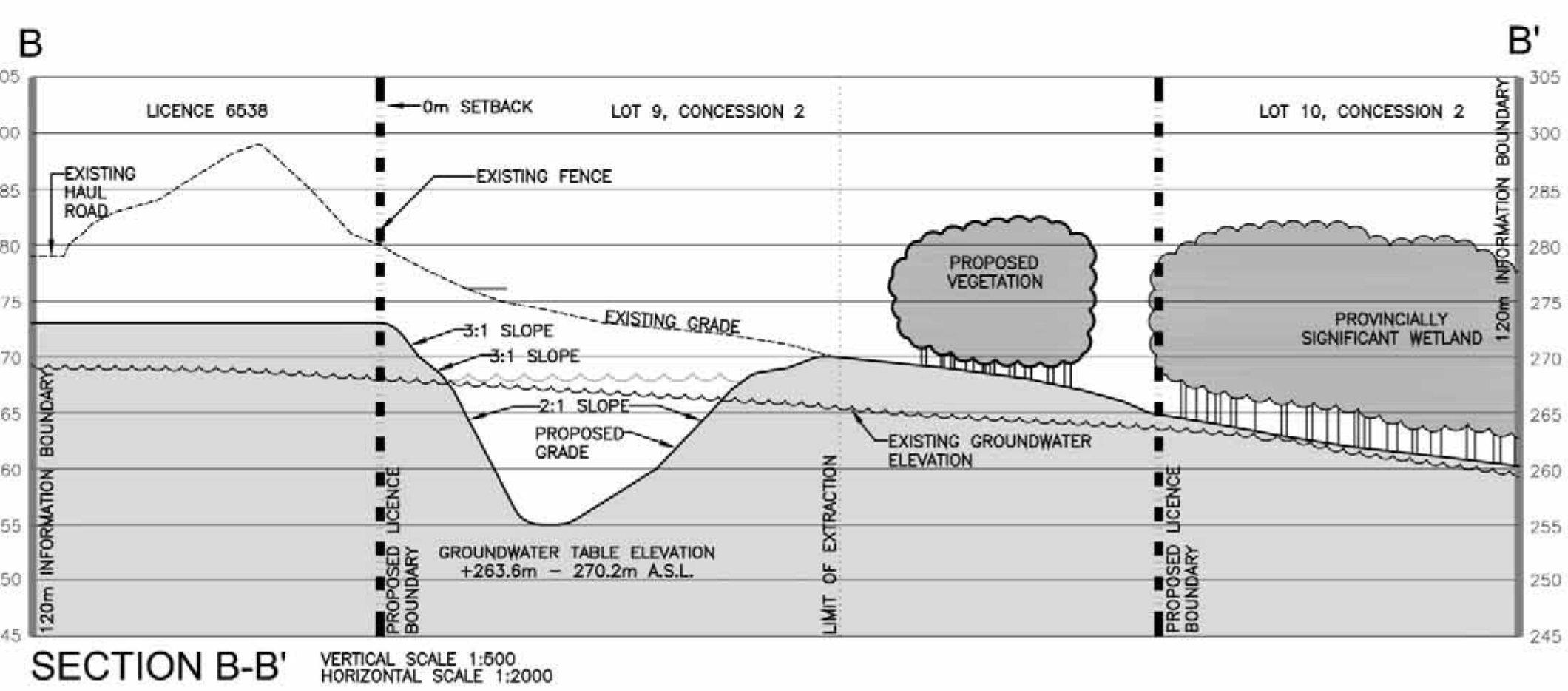
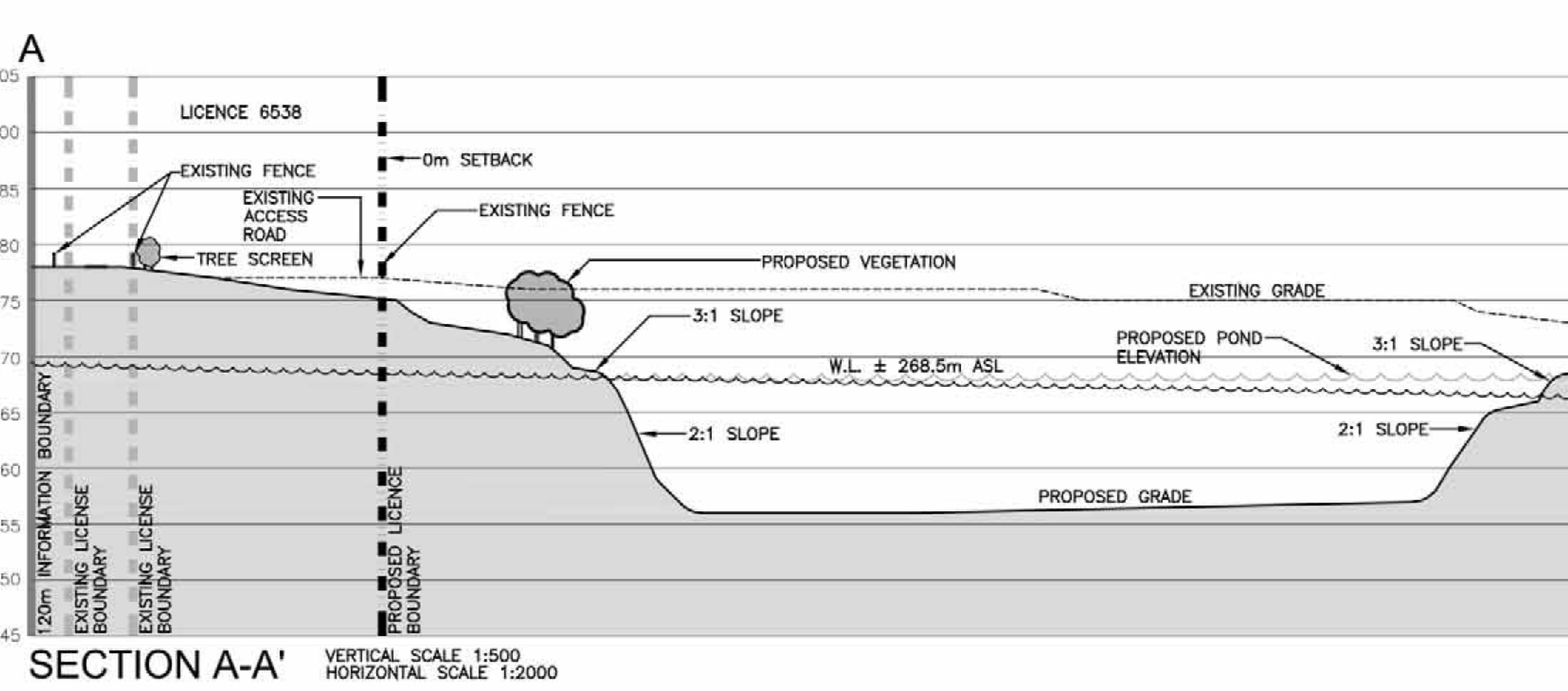
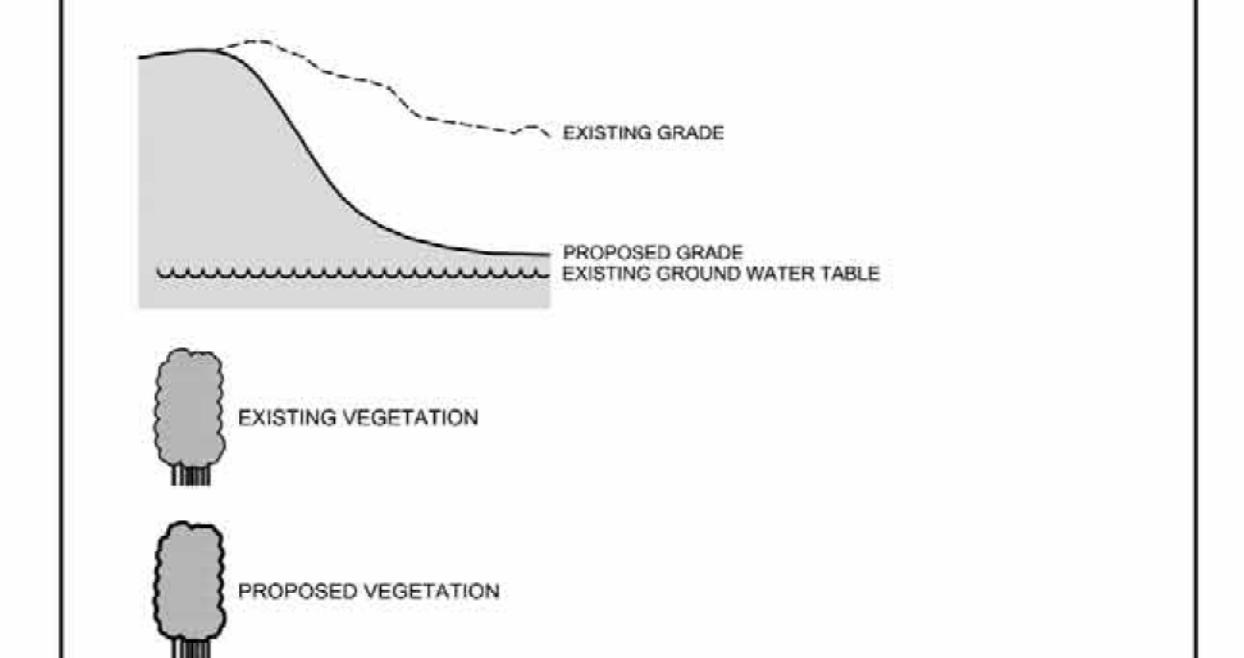

5	DEC 2022	PER NOMNRF COMMENTS
2	JUNE 2022	PER NOMNRF COMMENTS
1	NOV 2021	PER PUBLIC AND NOMNRF COMMENTS

Pre Licence Review Site Plan Amendments

41 Main Street, Unit 102
Unionville, Ontario L3R 2E5
Tel: 905-204-8252 Fax: 905-204-7623
www.harringtonmavon.com

Project Name

St. Marys Cement Inc. (Canada)
55 Industrial Street
Toronto, Ontario
M4G 3W9
(416) 423-1300

CBM Sunderland South Pit Expansion

APPLICANT SIGNATURE:
LICENCE No.
PART LOT 7 AND 8, CONCESSION 2
TOWNSHIP OF BROCK, REGION OF DURHAM

Scale 1:4000 North

Drawing Status SUBMITTED FOR NOMNRF APPROVAL

Drawn SB Checked RM Issue Date DEC 2022

Drawing Title OPERATIONAL PLAN PHASES B-D, AND SECTIONS

Project Number 18-44 Drawing Number 3 OF 4

